

SECTION A-A

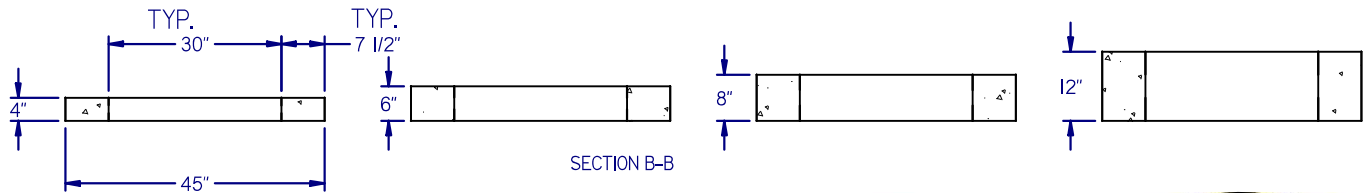

SECTION B-B

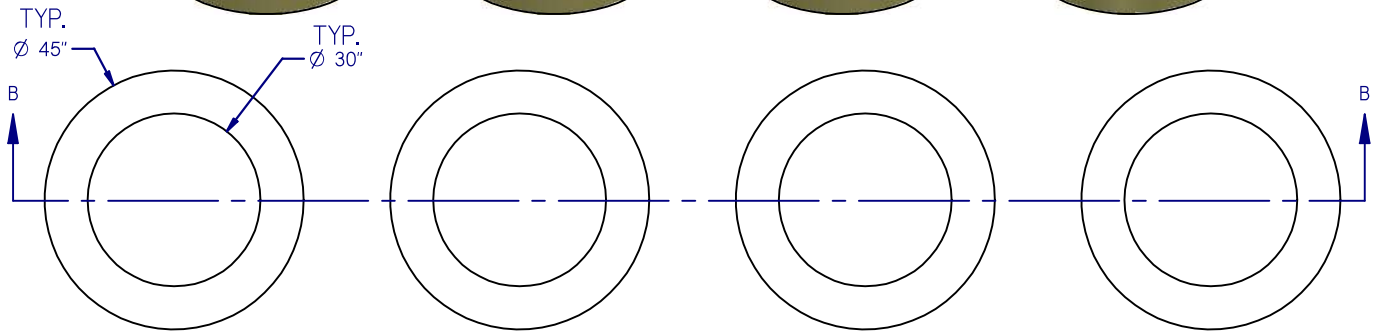
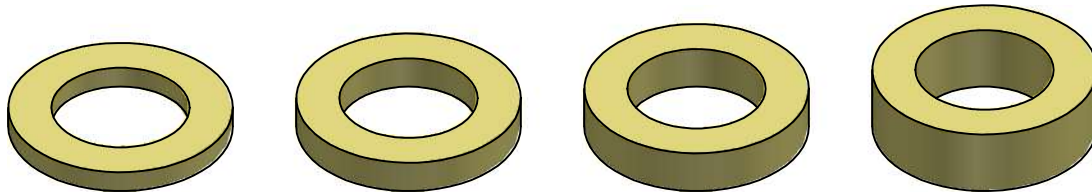
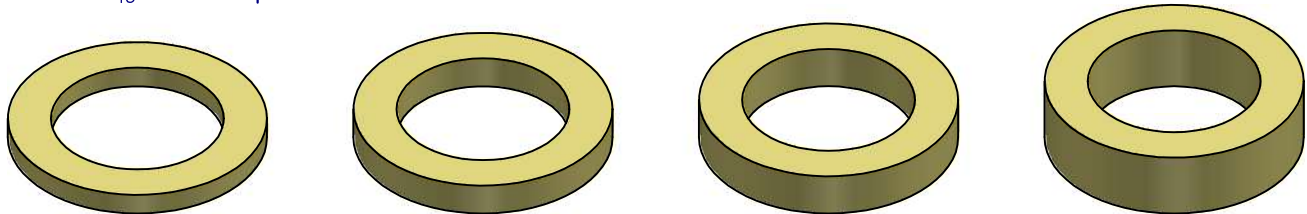

COMPONENT	WEIGHT (LBS.)
4 x 24	245
6 x 24	360
8 x 24	490
12 x 24	720
4 x 30	310
6 x 30	465
8 x 30	620
12 x 30	930

NOTES:

1. WEIGHT: SEE SCHEDULE AT RIGHT
2. CONCRETE: 5000 PSI AFTER 28 DAYS
3. MEET H 20 LOADING REQUIREMENTS
4. GRADE RINGS ARE UTILIZED TO BRING MANHOLE FRAMES AND COVERS UP TO FINISHED GRADE



CONCRETE GRADE RINGS

238 Country Club Road (Route 4) Sanford, ME 04073

(207) 324-7215 (800) 477-8177

Date: 9/10/2009